

Fasen: $C = (0,1 - 0,2) \times E$
 minimal 0,2 mm

Radius: $R = \max. 0,3 \times E$

Lauf: $t1$ für $Di \leq 20 \text{ mm} = 60 \mu\text{m}$
 $t1$ für $20 \text{ mm} < Di \leq 35 \text{ mm} = 80 \mu\text{m}$
 $t1$ für $Di > 35 \text{ mm} = 100 \mu\text{m}$

Einbautoleranz: Gehäuse H8
 Welle f7



| Artikel-Nr. | Artikel-Bezeichnung | Ø Innen | Ø Außen | Länge | Ø Flansch | Länge Flansch |
|-----------------------|------------------------------|---------|---------|--------|-----------|---------------|
| | | Di [mm] | Da [mm] | L [mm] | Dfl [mm] | Lfl [mm] |
| 11C003000600040009015 | C 3 / 6 x 4 (9 x 1,5) mm | 3 | 6 | 4 | 9 | 1,5 |
| 70C003000600050009015 | C 3 / 6 x 5 (9 x 1,5) mm | 3 | 6 | 5 | 9 | 1,5 |
| 11C003000600060009015 | C 3 / 6 x 6 (9 x 1,5) mm | 3 | 6 | 6 | 9 | 1,5 |
| 11C003000600100009015 | C 3 / 6 x 10 (9 x 1,5) mm | 3 | 6 | 10 | 9 | 1,5 |
| 11C004000800040012020 | C 4 / 8 x 4 (12 x 2) mm | 4 | 8 | 4 | 12 | 2 |
| 70C004000800050012020 | C 4 / 8 x 5 (12 x 2) mm | 4 | 8 | 5 | 12 | 2 |
| 11C004000800080012020 | C 4 / 8 x 8 (12 x 2) mm | 4 | 8 | 8 | 12 | 2 |
| 70C004000800100012020 | C 4 / 8 x 10 (12 x 2) mm | 4 | 8 | 10 | 12 | 2 |
| 11C004000800120012020 | C 4 / 8 x 12 (12 x 2) mm | 4 | 8 | 12 | 12 | 2 |
| 11C006001000060014020 | C 6 / 10 x 6 (14 x 2) mm | 6 | 10 | 6 | 14 | 2 |
| 11C006001000100014020 | C 6 / 10 x 10 (14 x 2) mm | 6 | 10 | 10 | 14 | 2 |
| 70C006001000150014020 | C 6 / 10 x 15 (14 x 2) mm | 6 | 10 | 15 | 14 | 2 |
| 11C006001000160014020 | C 6 / 10 x 16 (14 x 2) mm | 6 | 10 | 16 | 14 | 2 |
| 11C008001200080016020 | C 8 / 12 x 8 (16 x 2) mm | 8 | 12 | 8 | 16 | 2 |
| 70C008001200100016020 | C 8 / 12 x 10 (16 x 2) mm | 8 | 12 | 10 | 16 | 2 |
| 11C008001200120016020 | C 8 / 12 x 12 (16 x 2) mm | 8 | 12 | 12 | 16 | 2 |
| 11C008001200160016020 | C 8 / 12 x 16 (16 x 2) mm | 8 | 12 | 16 | 16 | 2 |
| 11C009001400060019025 | C 9 / 14 x 6 (19 x 2,5) mm | 9 | 14 | 6 | 19 | 2,5 |
| 11C009001400100019025 | C 9 / 14 x 10 (19 x 2,5) mm | 9 | 14 | 10 | 19 | 2,5 |
| 11C009001400140019025 | C 9 / 14 x 14 (19 x 2,5) mm | 9 | 14 | 14 | 19 | 2,5 |
| 11C010001300100016015 | C 10 / 13 x 10 (16 x 1,5) mm | 10 | 13 | 10 | 16 | 1,5 |
| 11C010001300160016015 | C 10 / 13 x 16 (16 x 1,5) mm | 10 | 13 | 16 | 16 | 1,5 |
| 11C010001300200016015 | C 10 / 13 x 20 (16 x 1,5) mm | 10 | 13 | 20 | 16 | 1,5 |
| 70C010001400100018020 | C 10 / 14 x 10 (18 x 2) mm | 10 | 14 | 10 | 18 | 2 |
| 70C010001400150018020 | C 10 / 14 x 15 (18 x 2) mm | 10 | 14 | 15 | 18 | 2 |
| 70C010001400200018020 | C 10 / 14 x 20 (18 x 2) mm | 10 | 14 | 20 | 18 | 2 |
| 11C010001500100020025 | C 10 / 15 x 10 (20 x 2,5) mm | 10 | 15 | 10 | 20 | 2,5 |
| 11C010001500160020025 | C 10 / 15 x 16 (20 x 2,5) mm | 10 | 15 | 16 | 20 | 2,5 |
| 11C010001500200020025 | C 10 / 15 x 20 (20 x 2,5) mm | 10 | 15 | 20 | 20 | 2,5 |
| 70C010001500100020030 | C 10 / 15 x 10 (20 x 3) mm | 10 | 15 | 10 | 20 | 3 |
| 70C010001500150020030 | C 10 / 15 x 15 (20 x 3) mm | 10 | 15 | 15 | 20 | 3 |
| 70C010001500160020030 | C 10 / 15 x 16 (20 x 3) mm | 10 | 15 | 16 | 20 | 3 |
| 70C010001500200020030 | C 10 / 15 x 20 (20 x 3) mm | 10 | 15 | 20 | 20 | 3 |
| 11C010001600080022030 | C 10 / 16 x 8 (22 x 3) mm | 10 | 16 | 8 | 22 | 3 |
| 11C010001600100022030 | C 10 / 16 x 10 (22 x 3) mm | 10 | 16 | 10 | 22 | 3 |
| 11C010001600160022030 | C 10 / 16 x 16 (22 x 3) mm | 10 | 16 | 16 | 22 | 3 |
| 11C012001500120018015 | C 12 / 15 x 12 (18 x 1,5) mm | 12 | 15 | 12 | 18 | 1,5 |
| 11C012001500160018015 | C 12 / 15 x 16 (18 x 1,5) mm | 12 | 15 | 16 | 18 | 1,5 |
| 11C012001500200018015 | C 12 / 15 x 20 (18 x 1,5) mm | 12 | 15 | 20 | 18 | 1,5 |

| Artikel-Nr. | Artikel-Bezeichnung | Ø Innen | Ø Außen | Länge | Ø Flansch | Länge Flansch |
|-----------------------|------------------------------|---------|---------|--------|-----------|---------------|
| | | Di [mm] | Da [mm] | L [mm] | Dfl [mm] | Lfl [mm] |
| 11C012001700120022025 | C 12 / 17 x 12 (22 x 2,5) mm | 12 | 17 | 12 | 22 | 2,5 |
| 11C012001700160022025 | C 12 / 17 x 16 (22 x 2,5) mm | 12 | 17 | 16 | 22 | 2,5 |
| 11C012001700200022025 | C 12 / 17 x 20 (22 x 2,5) mm | 12 | 17 | 20 | 22 | 2,5 |
| 11C012001700250022025 | C 12 / 17 x 25 (22 x 2,5) mm | 12 | 17 | 25 | 22 | 2,5 |
| 70C012001700100022030 | C 12 / 17 x 10 (22 x 3) mm | 12 | 17 | 10 | 22 | 3 |
| 70C012001700120022030 | C 12 / 17 x 12 (22 x 3) mm | 12 | 17 | 12 | 22 | 3 |
| 70C012001700150022030 | C 12 / 17 x 15 (22 x 3) mm | 12 | 17 | 15 | 22 | 3 |
| 70C012001700160022030 | C 12 / 17 x 16 (22 x 3) mm | 12 | 17 | 16 | 22 | 3 |
| 70C012001700200022030 | C 12 / 17 x 20 (22 x 3) mm | 12 | 17 | 20 | 22 | 3 |
| 70C012001700250022030 | C 12 / 17 x 25 (22 x 3) mm | 12 | 17 | 25 | 22 | 3 |
| 11C012001800080024030 | C 12 / 18 x 8 (24 x 3) mm | 12 | 18 | 8 | 24 | 3 |
| 11C012001800120024030 | C 12 / 18 x 12 (24 x 3) mm | 12 | 18 | 12 | 24 | 3 |
| 11C012001800200024030 | C 12 / 18 x 20 (24 x 3) mm | 12 | 18 | 20 | 24 | 3 |
| 11C014001800140022020 | C 14 / 18 x 14 (22 x 2) mm | 14 | 18 | 14 | 22 | 2 |
| 11C014001800180022020 | C 14 / 18 x 18 (22 x 2) mm | 14 | 18 | 18 | 22 | 2 |
| 11C014001800220022020 | C 14 / 18 x 22 (22 x 2) mm | 14 | 18 | 22 | 22 | 2 |
| 70C014002000140025030 | C 14 / 20 x 14 (25 x 3) mm | 14 | 20 | 14 | 25 | 3 |
| 70C014002000150025030 | C 14 / 20 x 15 (25 x 3) mm | 14 | 20 | 15 | 25 | 3 |
| 70C014002000180025030 | C 14 / 20 x 18 (25 x 3) mm | 14 | 20 | 18 | 25 | 3 |
| 70C014002000200025030 | C 14 / 20 x 20 (25 x 3) mm | 14 | 20 | 20 | 25 | 3 |
| 70C014002000220025030 | C 14 / 20 x 22 (25 x 3) mm | 14 | 20 | 22 | 25 | 3 |
| 70C014002000250025030 | C 14 / 20 x 25 (25 x 3) mm | 14 | 20 | 25 | 25 | 3 |
| 70C014002000280025030 | C 14 / 20 x 28 (25 x 3) mm | 14 | 20 | 28 | 25 | 3 |
| 70C014002000300025030 | C 14 / 20 x 30 (25 x 3) mm | 14 | 20 | 30 | 25 | 3 |
| 11C014002000140026030 | C 14 / 20 x 14 (26 x 3) mm | 14 | 20 | 14 | 26 | 3 |
| 11C014002000180026030 | C 14 / 20 x 18 (26 x 3) mm | 14 | 20 | 18 | 26 | 3 |
| 11C014002000220026030 | C 14 / 20 x 22 (26 x 3) mm | 14 | 20 | 22 | 26 | 3 |
| 11C014002000280026030 | C 14 / 20 x 28 (26 x 3) mm | 14 | 20 | 28 | 26 | 3 |
| 11C015001900160023020 | C 15 / 19 x 16 (23 x 2) mm | 15 | 19 | 16 | 23 | 2 |
| 11C015001900200023020 | C 15 / 19 x 20 (23 x 2) mm | 15 | 19 | 20 | 23 | 2 |
| 11C015001900250023020 | C 15 / 19 x 25 (23 x 2) mm | 15 | 19 | 25 | 23 | 2 |
| 70C015002000150025030 | C 15 / 20 x 15 (25 x 3) mm | 15 | 20 | 15 | 25 | 3 |
| 70C015002000200025030 | C 15 / 20 x 20 (25 x 3) mm | 15 | 20 | 20 | 25 | 3 |
| 70C015002000250025030 | C 15 / 20 x 25 (25 x 3) mm | 15 | 20 | 25 | 25 | 3 |
| 70C015002000300025030 | C 15 / 20 x 30 (25 x 3) mm | 15 | 20 | 30 | 25 | 3 |
| 11C015002100160027030 | C 15 / 21 x 16 (27 x 3) mm | 15 | 21 | 16 | 27 | 3 |
| 11C015002100200027030 | C 15 / 21 x 20 (27 x 3) mm | 15 | 21 | 20 | 27 | 3 |
| 11C015002100250027030 | C 15 / 21 x 25 (27 x 3) mm | 15 | 21 | 25 | 27 | 3 |
| 11C015002100320027030 | C 15 / 21 x 32 (27 x 3) mm | 15 | 21 | 32 | 27 | 3 |
| 11C016002000160024020 | C 16 / 20 x 16 (24 x 2) mm | 16 | 20 | 16 | 24 | 2 |
| 11C016002000200024020 | C 16 / 20 x 20 (24 x 2) mm | 16 | 20 | 20 | 24 | 2 |
| 11C016002000250024020 | C 16 / 20 x 25 (24 x 2) mm | 16 | 20 | 25 | 24 | 2 |
| 70C016002200150028030 | C 16 / 22 x 15 (28 x 3) mm | 16 | 22 | 15 | 28 | 3 |
| 11C016002200160028030 | C 16 / 22 x 16 (28 x 3) mm | 16 | 22 | 16 | 28 | 3 |
| 11C016002200200028030 | C 16 / 22 x 20 (28 x 3) mm | 16 | 22 | 20 | 28 | 3 |
| 11C016002200250028030 | C 16 / 22 x 25 (28 x 3) mm | 16 | 22 | 25 | 28 | 3 |
| 70C016002200300028030 | C 16 / 22 x 30 (28 x 3) mm | 16 | 22 | 30 | 28 | 3 |
| 11C016002200320028030 | C 16 / 22 x 32 (28 x 3) mm | 16 | 22 | 32 | 28 | 3 |
| 11C018002200180026020 | C 18 / 22 x 18 (26 x 2) mm | 18 | 22 | 18 | 26 | 2 |
| 11C018002200220026020 | C 18 / 22 x 22 (26 x 2) mm | 18 | 22 | 22 | 26 | 2 |
| 11C018002200280026020 | C 18 / 22 x 28 (26 x 2) mm | 18 | 22 | 28 | 26 | 2 |

| Artikel-Nr. | Artikel-Bezeichnung | Ø Innen | Ø Außen | Länge | Ø Flansch | Länge Flansch |
|-----------------------|------------------------------|---------|---------|--------|-----------|---------------|
| | | Di [mm] | Da [mm] | L [mm] | Dfl [mm] | Lfl [mm] |
| 11C018002400180030030 | C 18 / 24 x 18 (30 x 3) mm | 18 | 24 | 18 | 30 | 3 |
| 11C018002400220030030 | C 18 / 24 x 22 (30 x 3) mm | 18 | 24 | 22 | 30 | 3 |
| 11C018002400280030030 | C 18 / 24 x 28 (30 x 3) mm | 18 | 24 | 28 | 30 | 3 |
| 70C018002500200032040 | C 18 / 25 x 20 (32 x 4) mm | 18 | 25 | 20 | 32 | 4 |
| 70C018002500250032040 | C 18 / 25 x 25 (32 x 4) mm | 18 | 25 | 25 | 32 | 4 |
| 70C018002500300032040 | C 18 / 25 x 30 (32 x 4) mm | 18 | 25 | 30 | 32 | 4 |
| 70C018002500350032040 | C 18 / 25 x 35 (32 x 4) mm | 18 | 25 | 35 | 32 | 4 |
| 70C020002400100028020 | C 20 / 24 x 10 (28 x 2) mm | 20 | 24 | 10 | 28 | 2 |
| 11C020002400160028020 | C 20 / 24 x 16 (28 x 2) mm | 20 | 24 | 16 | 28 | 2 |
| 11C020002400200028020 | C 20 / 24 x 20 (28 x 2) mm | 20 | 24 | 20 | 28 | 2 |
| 11C020002400250028020 | C 20 / 24 x 25 (28 x 2) mm | 20 | 24 | 25 | 28 | 2 |
| 70C020002600150032030 | C 20 / 26 x 15 (32 x 3) mm | 20 | 26 | 15 | 32 | 3 |
| 11C020002600160032030 | C 20 / 26 x 16 (32 x 3) mm | 20 | 26 | 16 | 32 | 3 |
| 11C020002600200032030 | C 20 / 26 x 20 (32 x 3) mm | 20 | 26 | 20 | 32 | 3 |
| 11C020002600250032030 | C 20 / 26 x 25 (32 x 3) mm | 20 | 26 | 25 | 32 | 3 |
| 70C020002600300032030 | C 20 / 26 x 30 (32 x 3) mm | 20 | 26 | 30 | 32 | 3 |
| 11C020002600320032030 | C 20 / 26 x 32 (32 x 3) mm | 20 | 26 | 32 | 32 | 3 |
| 70C020002800200035040 | C 20 / 28 x 20 (35 x 4) mm | 20 | 28 | 20 | 35 | 4 |
| 70C020002800250035040 | C 20 / 28 x 25 (35 x 4) mm | 20 | 28 | 25 | 35 | 4 |
| 70C020002800350035040 | C 20 / 28 x 35 (35 x 4) mm | 20 | 28 | 35 | 35 | 4 |
| 11C022002700180032025 | C 22 / 27 x 18 (32 x 2,5) mm | 22 | 27 | 18 | 32 | 2,5 |
| 11C022002700220032025 | C 22 / 27 x 22 (32 x 2,5) mm | 22 | 27 | 22 | 32 | 2,5 |
| 11C022002700280032025 | C 22 / 27 x 28 (32 x 2,5) mm | 22 | 27 | 28 | 32 | 2,5 |
| 70C022002800150033040 | C 22 / 28 x 15 (33 x 4) mm | 22 | 28 | 15 | 33 | 4 |
| 70C022002800200033040 | C 22 / 28 x 20 (33 x 4) mm | 22 | 28 | 20 | 33 | 4 |
| 70C022002800250033040 | C 22 / 28 x 25 (33 x 4) mm | 22 | 28 | 25 | 33 | 4 |
| 70C022002800350033040 | C 22 / 28 x 35 (33 x 4) mm | 22 | 28 | 35 | 33 | 4 |
| 70C022002800400033040 | C 22 / 28 x 40 (33 x 4) mm | 22 | 28 | 40 | 33 | 4 |
| 11C022002800150034030 | C 22 / 28 x 15 (34 x 3) mm | 22 | 28 | 15 | 34 | 3 |
| 11C022002800200034030 | C 22 / 28 x 20 (34 x 3) mm | 22 | 28 | 20 | 34 | 3 |
| 11C022002800250034030 | C 22 / 28 x 25 (34 x 3) mm | 22 | 28 | 25 | 34 | 3 |
| 11C022002800300034030 | C 22 / 28 x 30 (34 x 3) mm | 22 | 28 | 30 | 34 | 3 |
| 11C022002900180036035 | C 22 / 29 x 18 (36 x 3,5) mm | 22 | 29 | 18 | 36 | 3,5 |
| 11C022002900220036035 | C 22 / 29 x 22 (36 x 3,5) mm | 22 | 29 | 22 | 36 | 3,5 |
| 11C022002900280036035 | C 22 / 29 x 28 (36 x 3,5) mm | 22 | 29 | 28 | 36 | 3,5 |
| 11C022002900360036035 | C 22 / 29 x 36 (36 x 3,5) mm | 22 | 29 | 36 | 36 | 3,5 |
| 11C025003000200035025 | C 25 / 30 x 20 (35 x 2,5) mm | 25 | 30 | 20 | 35 | 2,5 |
| 11C025003000250035025 | C 25 / 30 x 25 (35 x 2,5) mm | 25 | 30 | 25 | 35 | 2,5 |
| 11C025003000320035025 | C 25 / 30 x 32 (35 x 2,5) mm | 25 | 30 | 32 | 35 | 2,5 |
| 11C025003200200039035 | C 25 / 32 x 20 (39 x 3,5) mm | 25 | 32 | 20 | 39 | 3,5 |
| 11C025003200250039035 | C 25 / 32 x 25 (39 x 3,5) mm | 25 | 32 | 25 | 39 | 3,5 |
| 11C025003200320039035 | C 25 / 32 x 32 (39 x 3,5) mm | 25 | 32 | 32 | 39 | 3,5 |
| 70C025003200200040040 | C 25 / 32 x 20 (40 x 4) mm | 25 | 32 | 20 | 40 | 4 |
| 70C025003200250040040 | C 25 / 32 x 25 (40 x 4) mm | 25 | 32 | 25 | 40 | 4 |
| 70C025003200300040040 | C 25 / 32 x 30 (40 x 4) mm | 25 | 32 | 30 | 40 | 4 |
| 70C025003200350040040 | C 25 / 32 x 35 (40 x 4) mm | 25 | 32 | 35 | 40 | 4 |
| 70C025003200400040040 | C 25 / 32 x 40 (40 x 4) mm | 25 | 32 | 40 | 40 | 4 |
| 70C025003500160045050 | C 25 / 35 x 16 (45 x 5) mm | 25 | 35 | 16 | 45 | 5 |
| 70C025003500250045050 | C 25 / 35 x 25 (45 x 5) mm | 25 | 35 | 25 | 45 | 5 |
| 70C025003500300045050 | C 25 / 35 x 30 (45 x 5) mm | 25 | 35 | 30 | 45 | 5 |
| 11C028003300220038025 | C 28 / 33 x 22 (38 x 2,5) mm | 28 | 33 | 22 | 38 | 2,5 |

| Artikel-Nr. | Artikel-Bezeichnung | Ø Innen | Ø Außen | Länge | Ø Flansch | Länge Flansch |
|-----------------------|------------------------------|---------|---------|--------|-----------|---------------|
| | | Di [mm] | Da [mm] | L [mm] | Dfl [mm] | Lfl [mm] |
| 11C028003300280038025 | C 28 / 33 x 28 (38 x 2,5) mm | 28 | 33 | 28 | 38 | 2,5 |
| 11C028003300360038025 | C 28 / 33 x 36 (38 x 2,5) mm | 28 | 33 | 36 | 38 | 2,5 |
| 11C028003600220044040 | C 28 / 36 x 22 (44 x 4) mm | 28 | 36 | 22 | 44 | 4 |
| 70C028003600250044040 | C 28 / 36 x 25 (44 x 4) mm | 28 | 36 | 25 | 44 | 4 |
| 11C028003600280044040 | C 28 / 36 x 28 (44 x 4) mm | 28 | 36 | 28 | 44 | 4 |
| 70C028003600300044040 | C 28 / 36 x 30 (44 x 4) mm | 28 | 36 | 30 | 44 | 4 |
| 70C028003600350044040 | C 28 / 36 x 35 (44 x 4) mm | 28 | 36 | 35 | 44 | 4 |
| 11C028003600360044040 | C 28 / 36 x 36 (44 x 4) mm | 28 | 36 | 36 | 44 | 4 |
| 70C028003600400044040 | C 28 / 36 x 40 (44 x 4) mm | 28 | 36 | 40 | 44 | 4 |
| 11C030003800200046040 | C 30 / 38 x 20 (46 x 4) mm | 30 | 38 | 20 | 46 | 4 |
| 11C030003800250046040 | C 30 / 38 x 25 (46 x 4) mm | 30 | 38 | 25 | 46 | 4 |
| 11C030003800300046040 | C 30 / 38 x 30 (46 x 4) mm | 30 | 38 | 30 | 46 | 4 |
| 70C030004000250048040 | C 30 / 40 x 25 (48 x 4) mm | 30 | 40 | 25 | 48 | 4 |
| 70C030004000300048040 | C 30 / 40 x 30 (48 x 4) mm | 30 | 40 | 30 | 48 | 4 |
| 70C030004000350048040 | C 30 / 40 x 35 (48 x 4) mm | 30 | 40 | 35 | 48 | 4 |
| 70C030004000400048040 | C 30 / 40 x 40 (48 x 4) mm | 30 | 40 | 40 | 48 | 4 |
| 11C032003800200044030 | C 32 / 38 x 20 (44 x 3) mm | 32 | 38 | 20 | 44 | 3 |
| 11C032003800250044030 | C 32 / 38 x 25 (44 x 3) mm | 32 | 38 | 25 | 44 | 3 |
| 11C032003800320044030 | C 32 / 38 x 32 (44 x 3) mm | 32 | 38 | 32 | 44 | 3 |
| 11C032004000200048040 | C 32 / 40 x 20 (48 x 4) mm | 32 | 40 | 20 | 48 | 4 |
| 11C032004000250048040 | C 32 / 40 x 25 (48 x 4) mm | 32 | 40 | 25 | 48 | 4 |
| 11C032004000300048040 | C 32 / 40 x 30 (48 x 4) mm | 32 | 40 | 30 | 48 | 4 |
| 11C032004000320048040 | C 32 / 40 x 32 (48 x 4) mm | 32 | 40 | 32 | 48 | 4 |
| 70C032004000350048040 | C 32 / 40 x 35 (48 x 4) mm | 32 | 40 | 35 | 48 | 4 |
| 70C032004000400048040 | C 32 / 40 x 40 (48 x 4) mm | 32 | 40 | 40 | 48 | 4 |
| 70C035004200160045040 | C 35 / 42 x 16 (45 x 4) mm | 35 | 42 | 16 | 45 | 4 |
| 70C035004500200055050 | C 35 / 45 x 20 (55 x 5) mm | 35 | 45 | 20 | 55 | 5 |
| 70C035004500250055050 | C 35 / 45 x 25 (55 x 5) mm | 35 | 45 | 25 | 55 | 5 |
| 70C035004500300055050 | C 35 / 45 x 30 (55 x 5) mm | 35 | 45 | 30 | 55 | 5 |
| 70C035004500350055050 | C 35 / 45 x 35 (55 x 5) mm | 35 | 45 | 35 | 55 | 5 |
| 70C035004500400055050 | C 35 / 45 x 40 (55 x 5) mm | 35 | 45 | 40 | 55 | 5 |
| 11C036004200220048030 | C 36 / 42 x 22 (48 x 3) mm | 36 | 42 | 22 | 48 | 3 |
| 11C036004200280048030 | C 36 / 42 x 28 (48 x 3) mm | 36 | 42 | 28 | 48 | 3 |
| 11C036004200360048030 | C 36 / 42 x 36 (48 x 3) mm | 36 | 42 | 36 | 48 | 3 |
| 11C036004500220054045 | C 36 / 45 x 22 (54 x 4,5) mm | 36 | 45 | 22 | 54 | 4,5 |
| 11C036004500280054045 | C 36 / 45 x 28 (54 x 4,5) mm | 36 | 45 | 28 | 54 | 4,5 |
| 11C036004500360054045 | C 36 / 45 x 36 (54 x 4,5) mm | 36 | 45 | 36 | 54 | 4,5 |
| 11C040004600250052030 | C 40 / 46 x 25 (52 x 3) mm | 40 | 46 | 25 | 52 | 3 |
| 11C040004600320052030 | C 40 / 46 x 32 (52 x 3) mm | 40 | 46 | 32 | 52 | 3 |
| 11C040004600400052030 | C 40 / 46 x 40 (52 x 3) mm | 40 | 46 | 40 | 52 | 3 |
| 11C040005000250060050 | C 40 / 50 x 25 (60 x 5) mm | 40 | 50 | 25 | 60 | 5 |
| 70C040005000300060050 | C 40 / 50 x 30 (60 x 5) mm | 40 | 50 | 30 | 60 | 5 |
| 11C040005000320060050 | C 40 / 50 x 32 (60 x 5) mm | 40 | 50 | 32 | 60 | 5 |
| 70C040005000350060050 | C 40 / 50 x 35 (60 x 5) mm | 40 | 50 | 35 | 60 | 5 |
| 11C040005000400060050 | C 40 / 50 x 40 (60 x 5) mm | 40 | 50 | 40 | 60 | 5 |
| 11C045005100280057030 | C 45 / 51 x 28 (57 x 3) mm | 45 | 51 | 28 | 57 | 3 |
| 11C045005100360057030 | C 45 / 51 x 36 (57 x 3) mm | 45 | 51 | 36 | 57 | 3 |
| 11C045005100450057030 | C 45 / 51 x 45 (57 x 3) mm | 45 | 51 | 45 | 57 | 3 |
| 11C045005600280067055 | C 45 / 56 x 28 (67 x 5,5) mm | 45 | 56 | 28 | 67 | 5,5 |
| 11C045005600360067055 | C 45 / 56 x 36 (67 x 5,5) mm | 45 | 56 | 36 | 67 | 5,5 |
| 11C045005600450067055 | C 45 / 56 x 45 (67 x 5,5) mm | 45 | 56 | 45 | 67 | 5,5 |

| Artikel-Nr. | Artikel-Bezeichnung | Ø Innen | Ø Außen | Länge | Ø Flansch | Länge Flansch |
|-----------------------|----------------------------|---------|---------|--------|-----------|---------------|
| | | Di [mm] | Da [mm] | L [mm] | Dfl [mm] | Lfl [mm] |
| 11C050005600320062030 | C 50 / 56 x 32 (62 x 3) mm | 50 | 56 | 32 | 62 | 3 |
| 11C050005600400062030 | C 50 / 56 x 40 (62 x 3) mm | 50 | 56 | 40 | 62 | 3 |
| 11C050005600500062030 | C 50 / 56 x 50 (62 x 3) mm | 50 | 56 | 50 | 62 | 3 |
| 11C050006000320070050 | C 50 / 60 x 32 (70 x 5) mm | 50 | 60 | 32 | 70 | 5 |
| 11C050006000400070050 | C 50 / 60 x 40 (70 x 5) mm | 50 | 60 | 40 | 70 | 5 |
| 11C050006000500070050 | C 50 / 60 x 50 (70 x 5) mm | 50 | 60 | 50 | 70 | 5 |
| 11C060007000500080050 | C 60 / 70 x 50 (80 x 5) mm | 60 | 70 | 50 | 80 | 5 |
| 11C060007000600080050 | C 60 / 70 x 60 (80 x 5) mm | 60 | 70 | 60 | 80 | 5 |

Sinter-Zylinderbuchsen BRONZE
SINT A51

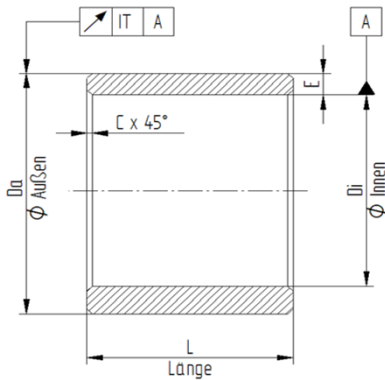

Fasen: $C = (0,1 - 0,2) \times E$
minimal 0,2 mm

Lauf: $Da < 50$ mm IT9
 $Da > 50$ mm IT10

Einbautoleranz: $Di < 50$ mm Gehäuse F7
Welle h7
 $Di > 50$ mm Gehäuse F8
Welle h7



| Artikel-Nr. | Artikel-Bezeichnung | Ø Innen | Ø Außen | Länge |
|-----------------|---------------------|---------|---------|--------|
| | | Di [mm] | Da [mm] | L [mm] |
| 17Z002000400040 | 2 / 4 x 4 mm | 2 | 4 | 4 |
| 17Z003000600100 | 3 / 6 x 10 mm | 3 | 6 | 10 |
| 17Z003000600040 | 3 / 6 x 4 mm | 3 | 6 | 4 |
| 17Z003000600060 | 3 / 6 x 6 mm | 3 | 6 | 6 |
| 17Z003000800040 | 3 / 8 x 4 mm | 3 | 8 | 4 |
| 17Z004000600060 | 4 / 6 x 6 mm | 4 | 6 | 6 |
| 17Z004000700120 | 4 / 7 x 12 mm | 4 | 7 | 12 |
| 17Z004000700040 | 4 / 7 x 4 mm | 4 | 7 | 4 |
| 17Z004000700080 | 4 / 7 x 8 mm | 4 | 7 | 8 |
| 17Z004000800120 | 4 / 8 x 12 mm | 4 | 8 | 12 |
| 17Z004000800040 | 4 / 8 x 4 mm | 4 | 8 | 4 |
| 17Z004000800060 | 4 / 8 x 6 mm | 4 | 8 | 6 |
| 17Z004000800080 | 4 / 8 x 8 mm | 4 | 8 | 8 |
| 17Z004001000080 | 4 / 10 x 8 mm | 4 | 10 | 8 |
| 17Z005000800080 | 5 / 8 x 8 mm | 5 | 8 | 8 |
| 17Z005000800100 | 5 / 8 x 10 mm | 5 | 8 | 10 |
| 17Z005000800160 | 5 / 8 x 16 mm | 5 | 8 | 16 |
| 17Z005001000060 | 5 / 10 x 6 mm | 5 | 10 | 6 |
| 17Z005001000100 | 5 / 10 x 10 mm | 5 | 10 | 10 |
| 17Z005001000080 | 5 / 10 x 8 mm | 5 | 10 | 8 |
| 17Z005001200100 | 5 / 12 x 10 mm | 5 | 12 | 10 |
| 17Z006000900040 | 6 / 9 x 4 mm | 6 | 9 | 4 |
| 17Z006000900060 | 6 / 9 x 6 mm | 6 | 9 | 6 |
| 17Z006000900100 | 6 / 9 x 10 mm | 6 | 9 | 10 |
| 17Z006000900120 | 6 / 9 x 12 mm | 6 | 9 | 12 |
| 17Z006000900160 | 6 / 9 x 16 mm | 6 | 9 | 16 |
| 17Z006001000040 | 6 / 10 x 4 mm | 6 | 10 | 4 |
| 17Z006001000060 | 6 / 10 x 6 mm | 6 | 10 | 6 |
| 17Z006001000100 | 6 / 10 x 10 mm | 6 | 10 | 10 |
| 17Z006001000160 | 6 / 10 x 16 mm | 6 | 10 | 16 |
| 17Z006001200060 | 6 / 12 x 6 mm | 6 | 12 | 6 |
| 17Z006001200080 | 6 / 12 x 8 mm | 6 | 12 | 8 |
| 17Z006001200120 | 6 / 12 x 12 mm | 6 | 12 | 12 |
| 17Z006001200160 | 6 / 12 x 16 mm | 6 | 12 | 16 |
| 17Z006001400120 | 6 / 14 x 12 mm | 6 | 14 | 12 |
| 17Z008001100060 | 8 / 11 x 6 mm | 8 | 11 | 6 |
| 17Z008001100080 | 8 / 11 x 8 mm | 8 | 11 | 8 |
| 17Z008001100120 | 8 / 11 x 12 mm | 8 | 11 | 12 |
| 17Z008001100160 | 8 / 11 x 16 mm | 8 | 11 | 16 |

| Artikel-Nr. | Artikel-Bezeichnung | Ø Innen | Ø Außen | Länge |
|-----------------|---------------------|---------|---------|--------|
| | | Di [mm] | Da [mm] | L [mm] |
| 17Z008001200060 | 8 / 12 x 6 mm | 8 | 12 | 6 |
| 17Z008001200080 | 8 / 12 x 8 mm | 8 | 12 | 8 |
| 17Z008001200100 | 8 / 12 x 10 mm | 8 | 12 | 10 |
| 17Z008001200120 | 8 / 12 x 12 mm | 8 | 12 | 12 |
| 17Z008001200160 | 8 / 12 x 16 mm | 8 | 12 | 16 |
| 17Z008001400080 | 8 / 14 x 8 mm | 8 | 14 | 8 |
| 17Z008001400120 | 8 / 14 x 12 mm | 8 | 14 | 12 |
| 17Z008001400160 | 8 / 14 x 16 mm | 8 | 14 | 16 |
| 17Z008001400200 | 8 / 14 x 20 mm | 8 | 14 | 20 |
| 17Z008001800160 | 8 / 18 x 16 mm | 8 | 18 | 16 |
| 17Z010001300100 | 10 / 13 x 10 mm | 10 | 13 | 10 |
| 17Z010001300160 | 10 / 13 x 16 mm | 10 | 13 | 16 |
| 17Z010001400080 | 10 / 14 x 8 mm | 10 | 14 | 8 |
| 17Z010001400100 | 10 / 14 x 10 mm | 10 | 14 | 10 |
| 17Z010001400120 | 10 / 14 x 12 mm | 10 | 14 | 12 |
| 17Z010001400160 | 10 / 14 x 16 mm | 10 | 14 | 16 |
| 17Z010001500100 | 10 / 15 x 10 mm | 10 | 15 | 10 |
| 17Z010001500160 | 10 / 15 x 16 mm | 10 | 15 | 16 |
| 17Z010001500200 | 10 / 15 x 20 mm | 10 | 15 | 20 |
| 17Z010001600080 | 10 / 16 x 8 mm | 10 | 16 | 8 |
| 17Z010001600100 | 10 / 16 x 10 mm | 10 | 16 | 10 |
| 17Z010001600160 | 10 / 16 x 16 mm | 10 | 16 | 16 |
| 17Z010001600200 | 10 / 16 x 20 mm | 10 | 16 | 20 |
| 17Z010002200200 | 10 / 22 x 20 mm | 10 | 22 | 20 |
| 17Z012001500120 | 12 / 15 x 12 mm | 12 | 15 | 12 |
| 17Z012001500160 | 12 / 15 x 16 mm | 12 | 15 | 16 |
| 17Z012001500200 | 12 / 15 x 20 mm | 12 | 15 | 20 |
| 17Z012001600080 | 12 / 16 x 8 mm | 12 | 16 | 8 |
| 17Z012001600120 | 12 / 16 x 12 mm | 12 | 16 | 12 |
| 17Z012001600200 | 12 / 16 x 20 mm | 12 | 16 | 20 |
| 17Z012001800080 | 12 / 18 x 8 mm | 12 | 18 | 8 |
| 17Z012001800120 | 12 / 18 x 12 mm | 12 | 18 | 12 |
| 17Z012001800160 | 12 / 18 x 16 mm | 12 | 18 | 16 |
| 17Z012001800200 | 12 / 18 x 20 mm | 12 | 18 | 20 |
| 17Z012001800250 | 12 / 18 x 25 mm | 12 | 18 | 25 |
| 17Z012002500250 | 12 / 25 x 25 mm | 12 | 25 | 25 |
| 17Z014001800100 | 14 / 18 x 10 mm | 14 | 18 | 10 |
| 17Z014001800140 | 14 / 18 x 14 mm | 14 | 18 | 14 |
| 17Z014001800200 | 14 / 18 x 20 mm | 14 | 18 | 20 |
| 17Z014002000100 | 14 / 20 x 10 mm | 14 | 20 | 10 |
| 17Z014002000120 | 14 / 20 x 12 mm | 14 | 20 | 12 |
| 17Z014002000140 | 14 / 20 x 14 mm | 14 | 20 | 14 |
| 17Z014002000200 | 14 / 20 x 20 mm | 14 | 20 | 20 |
| 17Z014002000300 | 14 / 20 x 30 mm | 14 | 20 | 30 |
| 17Z014002800300 | 14 / 28 x 30 mm | 14 | 28 | 30 |
| 17Z015001900100 | 15 / 19 x 10 mm | 15 | 19 | 10 |
| 17Z015001900150 | 15 / 19 x 15 mm | 15 | 19 | 15 |
| 17Z015001900250 | 15 / 19 x 25 mm | 15 | 19 | 25 |
| 17Z015002000100 | 15 / 20 x 10 mm | 15 | 20 | 10 |
| 17Z015002000150 | 15 / 20 x 15 mm | 15 | 20 | 15 |
| 17Z015002000200 | 15 / 20 x 20 mm | 15 | 20 | 20 |

| Artikel-Nr. | Artikel-Bezeichnung | Ø Innen | Ø Außen | Länge |
|-----------------|---------------------|---------|---------|--------|
| | | Di [mm] | Da [mm] | L [mm] |
| 17Z015002000250 | 15 / 20 x 25 mm | 15 | 20 | 25 |
| 17Z015002000300 | 15 / 20 x 30 mm | 15 | 20 | 30 |
| 17Z015002100100 | 15 / 21 x 10 mm | 15 | 21 | 10 |
| 17Z015002100150 | 15 / 21 x 15 mm | 15 | 21 | 15 |
| 17Z015002100250 | 15 / 21 x 25 mm | 15 | 21 | 25 |
| 17Z015002200160 | 15 / 22 x 16 mm | 15 | 22 | 16 |
| 17Z015002200200 | 15 / 22 x 20 mm | 15 | 22 | 20 |
| 17Z015002200300 | 15 / 22 x 30 mm | 15 | 22 | 30 |
| 17Z015003000300 | 15 / 30 x 30 mm | 15 | 30 | 30 |
| 17Z016002000120 | 16 / 20 x 12 mm | 16 | 20 | 12 |
| 17Z016002000150 | 16 / 20 x 15 mm | 16 | 20 | 15 |
| 17Z016002000160 | 16 / 20 x 16 mm | 16 | 20 | 16 |
| 17Z016002000200 | 16 / 20 x 20 mm | 16 | 20 | 20 |
| 17Z016002000250 | 16 / 20 x 25 mm | 16 | 20 | 25 |
| 17Z016002200120 | 16 / 22 x 12 mm | 16 | 22 | 12 |
| 17Z016002200160 | 16 / 22 x 16 mm | 16 | 22 | 16 |
| 17Z016002200200 | 16 / 22 x 20 mm | 16 | 22 | 20 |
| 17Z016002200250 | 16 / 22 x 25 mm | 16 | 22 | 25 |
| 17Z016002200300 | 16 / 22 x 30 mm | 16 | 22 | 30 |
| 17Z016003200300 | 16 / 32 x 30 mm | 16 | 32 | 30 |
| 17Z018002200120 | 18 / 22 x 12 mm | 18 | 22 | 12 |
| 17Z018002200180 | 18 / 22 x 18 mm | 18 | 22 | 18 |
| 17Z018002200300 | 18 / 22 x 30 mm | 18 | 22 | 30 |
| 17Z018002400120 | 18 / 24 x 12 mm | 18 | 24 | 12 |
| 17Z018002400180 | 18 / 24 x 18 mm | 18 | 24 | 18 |
| 17Z018002400300 | 18 / 24 x 30 mm | 18 | 24 | 30 |
| 17Z018002500160 | 18 / 25 x 16 mm | 18 | 25 | 16 |
| 17Z018002500200 | 18 / 25 x 20 mm | 18 | 25 | 20 |
| 17Z018002500300 | 18 / 25 x 30 mm | 18 | 25 | 30 |
| 17Z018003500300 | 18 / 35 x 30 mm | 18 | 35 | 30 |
| 17Z020002500150 | 20 / 25 x 15 mm | 20 | 25 | 15 |
| 17Z020002500200 | 20 / 25 x 20 mm | 20 | 25 | 20 |
| 17Z020002500250 | 20 / 25 x 25 mm | 20 | 25 | 25 |
| 17Z020002600150 | 20 / 26 x 15 mm | 20 | 26 | 15 |
| 17Z020002600200 | 20 / 26 x 20 mm | 20 | 26 | 20 |
| 17Z020002600250 | 20 / 26 x 25 mm | 20 | 26 | 25 |
| 17Z020002600300 | 20 / 26 x 30 mm | 20 | 26 | 30 |
| 17Z020002800200 | 20 / 28 x 20 mm | 20 | 28 | 20 |
| 17Z020002800300 | 20 / 28 x 30 mm | 20 | 28 | 30 |
| 17Z020002800400 | 20 / 28 x 40 mm | 20 | 28 | 40 |
| 17Z020004000400 | 20 / 40 x 40 mm | 20 | 40 | 40 |
| 17Z022002700150 | 22 / 27 x 15 mm | 22 | 27 | 15 |
| 17Z022002700200 | 22 / 27 x 20 mm | 22 | 27 | 20 |
| 17Z022002700250 | 22 / 27 x 25 mm | 22 | 27 | 25 |
| 17Z022003200200 | 22 / 32 x 20 mm | 22 | 32 | 20 |
| 17Z022003200300 | 22 / 32 x 30 mm | 22 | 32 | 30 |
| 17Z025003000200 | 25 / 30 x 20 mm | 25 | 30 | 20 |
| 17Z025003000250 | 25 / 30 x 25 mm | 25 | 30 | 25 |
| 17Z025003000300 | 25 / 30 x 30 mm | 25 | 30 | 30 |
| 17Z025003200200 | 25 / 32 x 20 mm | 25 | 32 | 20 |
| 17Z025003200250 | 25 / 32 x 25 mm | 25 | 32 | 25 |

| Artikel-Nr. | Artikel-Bezeichnung | Ø Innen | Ø Außen | Länge |
|-----------------|---------------------|---------|---------|--------|
| | | Di [mm] | Da [mm] | L [mm] |
| 17Z025003200300 | 25 / 32 x 30 mm | 25 | 32 | 30 |
| 17Z025003200350 | 25 / 32 x 35 mm | 25 | 32 | 35 |
| 17Z025003500200 | 25 / 35 x 20 mm | 25 | 35 | 20 |
| 17Z025003500250 | 25 / 35 x 25 mm | 25 | 35 | 25 |
| 17Z025003500350 | 25 / 35 x 35 mm | 25 | 35 | 35 |
| 17Z025003500500 | 25 / 35 x 50 mm | 25 | 35 | 50 |
| 17Z025004500350 | 25 / 45 x 35 mm | 25 | 45 | 35 |
| 17Z030003500200 | 30 / 35 x 20 mm | 30 | 35 | 20 |
| 17Z030003500250 | 30 / 35 x 25 mm | 30 | 35 | 25 |
| 17Z030003500300 | 30 / 35 x 30 mm | 30 | 35 | 30 |
| 17Z030003800200 | 30 / 38 x 20 mm | 30 | 38 | 20 |
| 17Z030003800250 | 30 / 38 x 25 mm | 30 | 38 | 25 |
| 17Z030003800300 | 30 / 38 x 30 mm | 30 | 38 | 30 |
| 17Z030003800400 | 30 / 38 x 40 mm | 30 | 38 | 40 |
| 17Z030004000150 | 30 / 40 x 15 mm | 30 | 40 | 15 |
| 17Z030004000300 | 30 / 40 x 30 mm | 30 | 40 | 30 |
| 17Z030004000450 | 30 / 40 x 45 mm | 30 | 40 | 45 |
| 17Z030004000600 | 30 / 40 x 60 mm | 30 | 40 | 60 |
| 17Z030005000600 | 30 / 50 x 60 mm | 30 | 50 | 60 |
| 17Z035004100250 | 35 / 41 x 25 mm | 35 | 41 | 25 |
| 17Z035004100350 | 35 / 41 x 35 mm | 35 | 41 | 35 |
| 17Z035004100400 | 35 / 41 x 40 mm | 35 | 41 | 40 |
| 17Z035004500250 | 35 / 45 x 25 mm | 35 | 45 | 25 |
| 17Z035004500500 | 35 / 45 x 50 mm | 35 | 45 | 50 |
| 17Z035004500700 | 35 / 45 x 70 mm | 35 | 45 | 70 |
| 17Z040004600300 | 40 / 46 x 30 mm | 40 | 46 | 30 |
| 17Z040004600400 | 40 / 46 x 40 mm | 40 | 46 | 40 |
| 17Z040004600500 | 40 / 46 x 50 mm | 40 | 46 | 50 |
| 17Z040005000300 | 40 / 50 x 30 mm | 40 | 50 | 30 |
| 17Z040005000400 | 40 / 50 x 40 mm | 40 | 50 | 40 |
| 17Z040005000500 | 40 / 50 x 50 mm | 40 | 50 | 50 |
| 17Z040005000600 | 40 / 50 x 60 mm | 40 | 50 | 60 |
| 17Z040005000800 | 40 / 50 x 80 mm | 40 | 50 | 80 |
| 17Z045005100350 | 45 / 51 x 35 mm | 45 | 51 | 35 |
| 17Z045005100450 | 45 / 51 x 45 mm | 45 | 51 | 45 |
| 17Z045005100550 | 45 / 51 x 55 mm | 45 | 51 | 55 |
| 17Z045005500350 | 45 / 55 x 35 mm | 45 | 55 | 35 |
| 17Z045005500450 | 45 / 55 x 45 mm | 45 | 55 | 45 |
| 17Z045005500550 | 45 / 55 x 55 mm | 45 | 55 | 55 |
| 17Z045005500600 | 45 / 55 x 60 mm | 45 | 55 | 60 |
| 17Z045005500650 | 45 / 55 x 65 mm | 45 | 55 | 65 |
| 17Z045006500800 | 45 / 65 x 80 mm | 45 | 65 | 80 |
| 17Z050006000350 | 50 / 60 x 35 mm | 50 | 60 | 35 |
| 17Z050006000500 | 50 / 60 x 50 mm | 50 | 60 | 50 |
| 17Z050006000700 | 50 / 60 x 70 mm | 50 | 60 | 70 |
| 17Z050006001000 | 50 / 60 x 100 mm | 50 | 60 | 100 |
| 17Z055006500400 | 55 / 65 x 40 mm | 55 | 65 | 40 |
| 17Z055006500550 | 55 / 65 x 55 mm | 55 | 65 | 55 |
| 17Z055006500700 | 55 / 65 x 70 mm | 55 | 65 | 70 |
| 17Z055007000700 | 55 / 70 x 70 mm | 55 | 70 | 70 |
| 17Z060006800500 | 60 / 68 x 50 mm | 60 | 68 | 50 |

| Artikel-Nr. | Artikel-Bezeichnung | Ø Innen | Ø Außen | Länge |
|-----------------|---------------------|---------|---------|--------|
| | | Di [mm] | Da [mm] | L [mm] |
| 17Z060006800600 | 60 / 68 x 60 mm | 60 | 68 | 60 |
| 17Z060006800700 | 60 / 68 x 70 mm | 60 | 68 | 70 |
| 17Z060007000500 | 60 / 70 x 50 mm | 60 | 70 | 50 |
| 17Z060007000600 | 60 / 70 x 60 mm | 60 | 70 | 60 |
| 17Z060007200500 | 60 / 72 x 50 mm | 60 | 72 | 50 |
| 17Z060007200600 | 60 / 72 x 60 mm | 60 | 72 | 60 |
| 17Z060007200700 | 60 / 72 x 70 mm | 60 | 72 | 70 |
| 17Z060007500600 | 60 / 75 x 60 mm | 60 | 75 | 60 |
| 17Z060007500900 | 60 / 75 x 90 mm | 60 | 75 | 90 |
| 17Z060008500900 | 60 / 85 x 90 mm | 60 | 85 | 90 |
| 17Z065007500600 | 65 / 75 x 60 mm | 65 | 75 | 60 |
| 17Z065007500900 | 65 / 75 x 90 mm | 65 | 75 | 90 |
| 17Z065008000600 | 65 / 80 x 60 mm | 65 | 80 | 60 |
| 17Z065008000900 | 65 / 80 x 90 mm | 65 | 80 | 90 |
| 17Z070008000600 | 70 / 80 x 60 mm | 70 | 80 | 60 |
| 17Z070008000900 | 70 / 80 x 90 mm | 70 | 80 | 90 |
| 17Z070008500600 | 70 / 85 x 60 mm | 70 | 85 | 60 |
| 17Z070008500900 | 70 / 85 x 90 mm | 70 | 85 | 90 |
| 17Z075008500700 | 75 / 85 x 70 mm | 75 | 85 | 70 |
| 17Z075008501000 | 75 / 85 x 100 mm | 75 | 85 | 100 |
| 17Z075009000700 | 75 / 90 x 70 mm | 75 | 90 | 70 |
| 17Z075009001000 | 75 / 90 x 100 mm | 75 | 90 | 100 |
| 17Z075010001000 | 75 / 100 x 100 mm | 75 | 100 | 100 |
| 17Z080009000700 | 80 / 90 x 70 mm | 80 | 90 | 70 |
| 17Z080009001000 | 80 / 90 x 100 mm | 80 | 90 | 100 |
| 17Z080009500700 | 80 / 95 x 70 mm | 80 | 95 | 70 |
| 17Z080009501000 | 80 / 95 x 100 mm | 80 | 95 | 100 |
| 17Z080010501000 | 80 / 105 x 100 mm | 80 | 105 | 100 |
| 17Z085009501000 | 85 / 95 x 100 mm | 85 | 95 | 100 |
| 17Z085010001000 | 85 / 100 x 100 mm | 85 | 100 | 100 |
| 17Z090010500800 | 90 / 105 x 80 mm | 90 | 105 | 80 |
| 17Z090011000800 | 90 / 110 x 80 mm | 90 | 110 | 80 |
| 17Z100012000800 | 100 / 120 x 80 mm | 100 | 120 | 80 |

Sinter-Zylinderbuchsen BRONZE
SINT B50 (DIN 1850) G7 / r6

helgerit

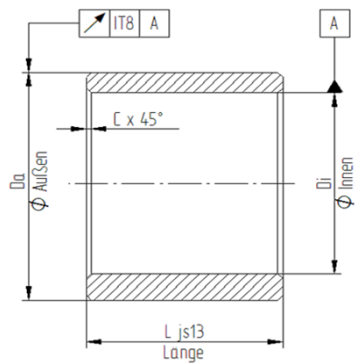

| Artikel-Nr. | Artikel-Bezeichnung | \varnothing Innen | \varnothing Außen | Länge | Fasen |
|-----------------|---------------------|---------------------|---------------------|--------|--------|
| | | Di [mm] | Da [mm] | L [mm] | C max. |
| 80Z003000600070 | 3 / 6 x 7 mm | 3 | 6 | 7 | 0,3 |
| 80Z004000800100 | 4 / 8 x 10 mm | 4 | 8 | 10 | 0,3 |
| 80Z005000900100 | 5 / 9 x 10 mm | 5 | 9 | 10 | 0,3 |
| 80Z006001000100 | 6 / 10 x 10 mm | 6 | 10 | 10 | 0,3 |
| 80Z006001200120 | 6 / 12 x 12 mm | 6 | 12 | 12 | 0,3 |
| 80Z008001200080 | 8 / 12 x 8 mm | 8 | 12 | 8 | 0,3 |
| 80Z008001200120 | 8 / 12 x 12 mm | 8 | 12 | 12 | 0,3 |
| 80Z008001200150 | 8 / 12 x 15 mm | 8 | 12 | 15 | 0,3 |
| 80Z010001600100 | 10 / 16 x 10 mm | 10 | 16 | 10 | 0,3 |
| 80Z010001600150 | 10 / 16 x 15 mm | 10 | 16 | 15 | 0,3 |
| 80Z010001600200 | 10 / 16 x 20 mm | 10 | 16 | 20 | 0,3 |
| 80Z012001800100 | 12 / 18 x 10 mm | 12 | 18 | 10 | 0,5 |
| 80Z012001800150 | 12 / 18 x 15 mm | 12 | 18 | 15 | 0,5 |
| 80Z012001800200 | 12 / 18 x 20 mm | 12 | 18 | 20 | 0,5 |
| 80Z014002000200 | 14 / 20 x 20 mm | 14 | 20 | 20 | 0,5 |
| 80Z015002000150 | 15 / 20 x 15 mm | 15 | 20 | 15 | 0,5 |
| 80Z016002000250 | 16 / 20 x 25 mm | 16 | 20 | 25 | 0,5 |
| 80Z016002200150 | 16 / 22 x 15 mm | 16 | 22 | 15 | 0,5 |
| 80Z016002200250 | 16 / 22 x 25 mm | 16 | 22 | 25 | 0,5 |
| 80Z018002500250 | 18 / 25 x 25 mm | 18 | 25 | 25 | 0,5 |
| 80Z020002600200 | 20 / 26 x 20 mm | 20 | 26 | 20 | 0,5 |
| 80Z020002600300 | 20 / 26 x 30 mm | 20 | 26 | 30 | 0,5 |
| 80Z020003000200 | 20 / 30 x 20 mm | 20 | 30 | 20 | 0,5 |
| 80Z020003000300 | 20 / 30 x 30 mm | 20 | 30 | 30 | 0,5 |
| 80Z022002800200 | 22 / 28 x 20 mm | 22 | 28 | 20 | 0,5 |
| 80Z022002800300 | 22 / 28 x 30 mm | 22 | 28 | 30 | 0,5 |
| 80Z025003200250 | 25 / 32 x 25 mm | 25 | 32 | 25 | 0,5 |
| 80Z025003200350 | 25 / 32 x 35 mm | 25 | 32 | 35 | 0,5 |
| 80Z028003600250 | 28 / 36 x 25 mm | 28 | 36 | 25 | 0,5 |
| 80Z028003600350 | 28 / 36 x 35 mm | 28 | 36 | 35 | 0,5 |
| 80Z030003800300 | 30 / 38 x 30 mm | 30 | 38 | 30 | 0,5 |
| 80Z030003800400 | 30 / 38 x 40 mm | 30 | 38 | 40 | 0,5 |
| 80Z030004000300 | 30 / 40 x 30 mm | 30 | 40 | 30 | 0,5 |
| 80Z030004000400 | 30 / 40 x 40 mm | 30 | 40 | 40 | 0,5 |
| 80Z032004000400 | 32 / 40 x 40 mm | 32 | 40 | 40 | 0,8 |
| 80Z035004500350 | 35 / 45 x 35 mm | 35 | 45 | 35 | 0,8 |
| 80Z035004500450 | 35 / 45 x 45 mm | 35 | 45 | 45 | 0,8 |
| 80Z040005000500 | 40 / 50 x 50 mm | 40 | 50 | 50 | 0,8 |
| 80Z045005000350 | 45 / 50 x 35 mm | 45 | 50 | 35 | 0,8 |
| 80Z050006000500 | 50 / 60 x 50 mm | 50 | 60 | 50 | 0,8 |

Sinter-Flanschbuchsen BRONZE SINT A51

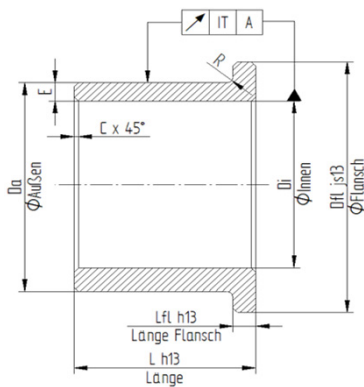

Fasen: $C = (0,1 - 0,2) \times E$
minimal 0,2 mm

Radius: $R = \max. 0,3 \times E$

Lauf: $Da < 50 \text{ mm}$ IT9
 $Da > 50 \text{ mm}$ IT10

Einbautoleranz: $Da < 50 \text{ mm}$ Gehäuse F7 Welle h7
 $Da < 50 \text{ mm}$ Gehäuse F8 Welle h7



| Artikel-Nr. | Artikel-Bezeichnung | Ø Innen | Ø Außen | Länge | Ø Flansch | Länge Flansch |
|-----------------------|------------------------------|---------|---------|--------|-----------|---------------|
| | | Di [mm] | Da [mm] | L [mm] | Dfl [mm] | Lfl [mm] |
| 17C003000500040008015 | C 3 / 5 x 4 (8 x 1,5) mm | 3 | 5 | 4 | 8 | 1,5 |
| 17C003000500040009015 | C 3 / 6 x 4 (9 x 1,5) mm | 3 | 6 | 4 | 9 | 1,5 |
| 17C003000600060009015 | C 3 / 6 x 6 (9 x 1,5) mm | 3 | 6 | 6 | 9 | 1,5 |
| 17C003000600100009015 | C 3 / 6 x 10 (9 x 1,5) mm | 3 | 6 | 10 | 9 | 1,5 |
| 17C004000800060010015 | C 4 / 8 x 6 (10 x 1,5) mm | 4 | 8 | 6 | 10 | 1,5 |
| 17C004000800040012020 | C 4 / 8 x 4 (12 x 2) mm | 4 | 8 | 4 | 12 | 2 |
| 17C004000800060012020 | C 4 / 8 x 6 (12 x 2) mm | 4 | 8 | 6 | 12 | 2 |
| 17C005000900040013020 | C 5 / 9 x 4 (13 x 2) mm | 5 | 9 | 4 | 13 | 2 |
| 17C005000900050013020 | C 5 / 9 x 5 (13 x 2) mm | 5 | 9 | 5 | 13 | 2 |
| 17C005000900080013020 | C 5 / 9 x 8 (13 x 2) mm | 5 | 9 | 8 | 13 | 2 |
| 17C005001000060012020 | C 5 / 10 x 6 (12 x 2) mm | 5 | 10 | 6 | 12 | 2 |
| 17C006001000040014020 | C 6 / 10 x 4 (14 x 2) mm | 6 | 10 | 4 | 14 | 2 |
| 17C006001000060014020 | C 6 / 10 x 6 (14 x 2) mm | 6 | 10 | 6 | 14 | 2 |
| 17C006001000100014020 | C 6 / 10 x 10 (14 x 2) mm | 6 | 10 | 10 | 14 | 2 |
| 17C006001200060014020 | C 6 / 12 x 6 (14 x 2) mm | 6 | 12 | 6 | 14 | 2 |
| 17C008001200050016020 | C 8 / 12 x 5 (16 x 2) mm | 8 | 12 | 5 | 16 | 2 |
| 17C008001200060016020 | C 8 / 12 x 6 (16 x 2) mm | 8 | 12 | 6 | 16 | 2 |
| 17C008001200080016020 | C 8 / 12 x 8 (16 x 2) mm | 8 | 12 | 8 | 16 | 2 |
| 17C008001200100016020 | C 8 / 12 x 10 (16 x 2) mm | 8 | 12 | 10 | 16 | 2 |
| 17C008001200120016020 | C 8 / 12 x 12 (16 x 2) mm | 8 | 12 | 12 | 16 | 2 |
| 17C008001400080018030 | C 8 / 14 x 8 (18 x 3) mm | 8 | 14 | 8 | 18 | 3 |
| 17C010001300100016015 | C 10 / 13 x 10 (16 x 1,5) mm | 10 | 13 | 10 | 16 | 1,5 |
| 17C010001300160016015 | C 10 / 13 x 16 (16 x 1,5) mm | 10 | 13 | 16 | 16 | 1,5 |
| 17C010001300200016015 | C 10 / 13 x 20 (16 x 1,5) mm | 10 | 13 | 20 | 16 | 1,5 |
| 17C010001600080020030 | C 10 / 16 x 8 (20 x 3) mm | 10 | 16 | 8 | 20 | 3 |
| 17C010001600100020030 | C 10 / 16 x 10 (20 x 3) mm | 10 | 16 | 10 | 20 | 3 |
| 17C010001600080022030 | C 10 / 16 x 8 (22 x 3) mm | 10 | 16 | 8 | 22 | 3 |
| 17C010001600100022030 | C 10 / 16 x 10 (22 x 3) mm | 10 | 16 | 10 | 22 | 3 |
| 17C010001600160022030 | C 10 / 16 x 16 (22 x 3) mm | 10 | 16 | 16 | 22 | 3 |
| 17C012001800100022030 | C 12 / 18 x 10 (22 x 3) mm | 12 | 18 | 10 | 22 | 3 |
| 17C012001800120022030 | C 12 / 18 x 12 (22 x 3) mm | 12 | 18 | 12 | 22 | 3 |
| 17C012001800080024030 | C 12 / 18 x 8 (24 x 3) mm | 12 | 18 | 8 | 24 | 3 |
| 17C012001800120024030 | C 12 / 18 x 12 (24 x 3) mm | 12 | 18 | 12 | 24 | 3 |
| 17C012001800200024030 | C 12 / 18 x 20 (24 x 3) mm | 12 | 18 | 20 | 24 | 3 |
| 17C014002000100025030 | C 14 / 20 x 10 (25 x 3) mm | 14 | 20 | 10 | 25 | 3 |
| 17C014002000120025030 | C 14 / 20 x 12 (25 x 3) mm | 14 | 20 | 12 | 25 | 3 |
| 17C014002000100026030 | C 14 / 20 x 10 (26 x 3) mm | 14 | 20 | 10 | 26 | 3 |
| 17C014002000140026030 | C 14 / 20 x 14 (26 x 3) mm | 14 | 20 | 14 | 26 | 3 |
| 17C014002000200026030 | C 14 / 20 x 20 (26 x 3) mm | 14 | 20 | 20 | 26 | 3 |

| Artikel-Nr. | Artikel-Bezeichnung | Ø Innen | Ø Außen | Länge | Ø Flansch | Länge Flansch |
|-----------------------|------------------------------|---------|---------|--------|-----------|---------------|
| | | Di [mm] | Da [mm] | L [mm] | Dfl [mm] | Lfl [mm] |
| 17C015002000150027030 | C 15 / 20 x 15 (27 x 3) mm | 15 | 20 | 15 | 27 | 3 |
| 17C015002000250027030 | C 15 / 20 x 25 (27 x 3) mm | 15 | 20 | 25 | 27 | 3 |
| 17C015002100100027030 | C 15 / 21 x 10 (27 x 3) mm | 15 | 21 | 10 | 27 | 3 |
| 17C015002100150027030 | C 15 / 21 x 15 (27 x 3) mm | 15 | 21 | 15 | 27 | 3 |
| 17C015002100250027030 | C 15 / 21 x 25 (27 x 3) mm | 15 | 21 | 25 | 27 | 3 |
| 17C015002200120028030 | C 15 / 22 x 12 (28 x 3) mm | 15 | 22 | 12 | 28 | 3 |
| 17C015002200160028030 | C 15 / 22 x 16 (28 x 3) mm | 15 | 22 | 16 | 28 | 3 |
| 17C016002200120028030 | C 16 / 22 x 12 (28 x 3) mm | 16 | 22 | 12 | 28 | 3 |
| 17C016002200160028030 | C 16 / 22 x 16 (28 x 3) mm | 16 | 22 | 16 | 28 | 3 |
| 17C016002200250028030 | C 16 / 22 x 25 (28 x 3) mm | 16 | 22 | 25 | 28 | 3 |
| 17C016002200120028040 | C 16 / 22 x 12 (28 x 4) mm | 16 | 22 | 12 | 28 | 4 |
| 17C016002200160028040 | C 16 / 22 x 16 (28 x 4) mm | 16 | 22 | 16 | 28 | 4 |
| 17C018002400120030030 | C 18 / 24 x 12 (30 x 3) mm | 18 | 24 | 12 | 30 | 3 |
| 17C018002400180030030 | C 18 / 24 x 18 (30 x 3) mm | 18 | 24 | 18 | 30 | 3 |
| 17C018002400300030030 | C 18 / 24 x 30 (30 x 3) mm | 18 | 24 | 30 | 30 | 3 |
| 17C018002500120032040 | C 18 / 25 x 12 (32 x 4) mm | 18 | 25 | 12 | 32 | 4 |
| 17C018002500160032040 | C 18 / 25 x 16 (32 x 4) mm | 18 | 25 | 16 | 32 | 4 |
| 17C020002600150032030 | C 20 / 26 x 15 (32 x 3) mm | 20 | 26 | 15 | 32 | 3 |
| 17C020002600200032030 | C 20 / 26 x 20 (32 x 3) mm | 20 | 26 | 20 | 32 | 3 |
| 17C020002600250032030 | C 20 / 26 x 25 (32 x 3) mm | 20 | 26 | 25 | 32 | 3 |
| 17C020002600300032030 | C 20 / 26 x 30 (32 x 3) mm | 20 | 26 | 30 | 32 | 3 |
| 17C020002800160035040 | C 20 / 28 x 16 (35 x 4) mm | 20 | 28 | 16 | 35 | 4 |
| 17C020002800200035040 | C 20 / 28 x 20 (35 x 4) mm | 20 | 28 | 20 | 35 | 4 |
| 17C025003200200039035 | C 25 / 32 x 20 (39 x 3,5) mm | 25 | 32 | 20 | 39 | 3,5 |
| 17C025003200250039035 | C 25 / 32 x 25 (39 x 3,5) mm | 25 | 32 | 25 | 39 | 3,5 |
| 17C025003200300039035 | C 25 / 32 x 30 (39 x 3,5) mm | 25 | 32 | 30 | 39 | 3,5 |
| 17C025003500160045050 | C 25 / 35 x 16 (45 x 5) mm | 25 | 35 | 16 | 45 | 5 |
| 17C025003500250045050 | C 25 / 35 x 25 (45 x 5) mm | 25 | 35 | 25 | 45 | 5 |
| 17C030003800200046040 | C 30 / 38 x 20 (46 x 4) mm | 30 | 38 | 20 | 46 | 4 |
| 17C030003800250046040 | C 30 / 38 x 25 (46 x 4) mm | 30 | 38 | 25 | 46 | 4 |
| 17C030003800300046040 | C 30 / 38 x 30 (46 x 4) mm | 30 | 38 | 30 | 46 | 4 |
| 17C030004000200050050 | C 30 / 40 x 20 (50 x 5) mm | 30 | 40 | 20 | 50 | 5 |
| 17C030004000300050050 | C 30 / 40 x 30 (50 x 5) mm | 30 | 40 | 30 | 50 | 5 |
| 17C035004500200055050 | C 35 / 45 x 20 (55 x 5) mm | 35 | 45 | 20 | 55 | 5 |
| 17C035004500250055050 | C 35 / 45 x 25 (55 x 5) mm | 35 | 45 | 25 | 55 | 5 |
| 17C035004500350055050 | C 35 / 45 x 35 (55 x 5) mm | 35 | 45 | 35 | 55 | 5 |
| 17C035004500400055050 | C 35 / 45 x 40 (55 x 5) mm | 35 | 45 | 40 | 55 | 5 |
| 17C038004800350060050 | C 38 / 48 x 35 (60 x 5) mm | 38 | 48 | 35 | 60 | 5 |
| 17C040005000250060050 | C 40 / 50 x 25 (60 x 5) mm | 40 | 50 | 25 | 60 | 5 |
| 17C040005000300060050 | C 40 / 50 x 30 (60 x 5) mm | 40 | 50 | 30 | 60 | 5 |
| 17C040005000400060050 | C 40 / 50 x 40 (60 x 5) mm | 40 | 50 | 40 | 60 | 5 |
| 17C040005000500060050 | C 40 / 50 x 50 (60 x 5) mm | 40 | 50 | 50 | 60 | 5 |
| 17C040005000250060060 | C 40 / 50 x 25 (60 x 6) mm | 40 | 50 | 25 | 60 | 6 |
| 17C040005000400060060 | C 40 / 50 x 40 (60 x 6) mm | 40 | 50 | 40 | 60 | 6 |
| 17C045005500350065050 | C 45 / 55 x 35 (65 x 5) mm | 45 | 55 | 35 | 65 | 5 |
| 17C045005500450065050 | C 45 / 55 x 45 (65 x 5) mm | 45 | 55 | 45 | 65 | 5 |
| 17C045005500550065050 | C 45 / 55 x 55 (65 x 5) mm | 45 | 55 | 55 | 65 | 5 |
| 17C045005500300065060 | C 45 / 55 x 30 (65 x 6) mm | 45 | 55 | 30 | 65 | 6 |
| 17C045005500450065060 | C 45 / 55 x 45 (65 x 6) mm | 45 | 55 | 45 | 65 | 6 |
| 17C050006000350070050 | C 50 / 60 x 35 (70 x 5) mm | 50 | 60 | 35 | 70 | 5 |
| 17C050006000500070050 | C 50 / 60 x 50 (70 x 5) mm | 50 | 60 | 50 | 70 | 5 |

| Artikel-Nr. | Artikel-Bezeichnung | Ø Innen | Ø Außen | Länge | Ø Flansch | Länge Flansch |
|-----------------------|-------------------------------|---------|---------|--------|-----------|---------------|
| | | Di [mm] | Da [mm] | L [mm] | Dfl [mm] | Lfl [mm] |
| 17C050006000300070060 | C 50 / 60 x 30 (70 x 6) mm | 50 | 60 | 30 | 70 | 6 |
| 17C050006000500070060 | C 50 / 60 x 50 (70 x 6) mm | 50 | 60 | 50 | 70 | 6 |
| 17C060007200500084060 | C 60 / 72 x 50 (84 x 6) mm | 60 | 72 | 50 | 84 | 6 |
| 17C060007200600084060 | C 60 / 72 x 60 (84 x 6) mm | 60 | 72 | 60 | 84 | 6 |
| 17C060007500350085080 | C 60 / 75 x 35 (85 x 8) mm | 60 | 75 | 35 | 85 | 8 |
| 17C060007500600085080 | C 60 / 75 x 60 (85 x 8) mm | 60 | 75 | 60 | 85 | 8 |
| 17C070008500600095080 | C 70 / 85 x 60 (95 x 8) mm | 70 | 85 | 60 | 95 | 8 |
| 17C080009500700105080 | C 80 / 95 x 70 (105 x 8) mm | 80 | 95 | 70 | 105 | 8 |
| 17C090011000500120080 | C 90 / 110 x 50 (120 x 8) mm | 90 | 110 | 50 | 120 | 8 |
| 17C100012000800130080 | C 100 / 120 x 80 (130 x 8) mm | 100 | 120 | 80 | 130 | 8 |

Sinter-Flanschbuchsen BRONZE
SINT B50 (DIN 1850) G7 / r7

helgerit

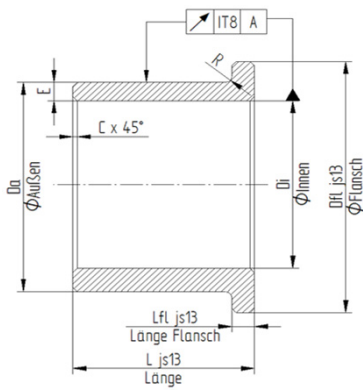

| Artikel-Nr. | Artikel-Bezeichnung | Ø Innen | Ø Außen | Länge | Ø Flansch | Länge Flansch |
|-----------------------|----------------------------|---------|---------|--------|-----------|---------------|
| | | Di [mm] | Da [mm] | L [mm] | Dfl [mm] | Lfl [mm] |
| 80C004000800060010020 | C 4 / 8 x 6 (10 x 2) mm | 4 | 8 | 6 | 10 | 2 |
| 80C006001000100012020 | C 6 / 10 x 10 (12 x 2) mm | 6 | 10 | 10 | 12 | 2 |
| 80C008001200150014020 | C 8 / 12 x 15 (14 x 2) mm | 8 | 12 | 15 | 14 | 2 |
| 80C010001600200020020 | C 10 / 16 x 20 (20 x 2) mm | 10 | 16 | 20 | 20 | 2 |
| 80C012001600200018020 | C 12 / 16 x 20 (18 x 2) mm | 12 | 16 | 20 | 18 | 2 |
| 80C014002000250023030 | C 14 / 20 x 25 (23 x 3) mm | 14 | 20 | 25 | 23 | 3 |
| 80C016002200200028030 | C 16 / 22 x 20 (28 x 3) mm | 16 | 22 | 20 | 28 | 3 |
| 80C018002400300032030 | C 18 / 24 x 30 (32 x 3) mm | 18 | 24 | 30 | 32 | 3 |
| 80C020002600300032030 | C 20 / 26 x 30 (32 x 3) mm | 20 | 26 | 30 | 32 | 3 |